



Mano a Mano Bolivia

Voluntariado de apoyo a la salud y desarrollo social



Project:

Huayquiri School

Construction and Equipment



HUAYQUIRI SCHOOL PROJECT

CONSTRUCTION – EQUIPMENT OF SCHOOL CLASSROOMS HOUSING FOR TEACHERS AND BATHROOM

Huayquiri Community Summary

State: La Paz **Province:** Loayza **Municipality:** Luribay
Population: 355 habitants
Others benefited communities: Cotaña, Cala Cala, Oquepampa.
Available basic services: Clean water, electric energy.
Distance from the city of Cochabamba: 372 km

Introduction

Mano a Mano Bolivia is a non-governmental non-profit organization, recognized in Bolivia, and has been working since 1995, supporting social development through the implementation of health, school, and road infrastructure projects, as well as other health and education programs. The Organization is composed of a multidisciplinary team of workers and volunteers.

Many communities with limited economic resources in our country, cannot develop with their own resources health infrastructure, schools and road access, as a result their economic and social development is delayed, reflected in:

- Low Human Development Index.
- High maternal and child mortality rates.
- High dropout rates.
- Limited support from government programs due to the lack of adequate infrastructure.
- High rate of migration from rural populations to cities.

All this increases the inequality gap, which increases poverty for these regions of Bolivia.

To this day in the area of social infrastructure Mano a Mano Bolivia has built throughout the country:

- **190** Health Infrastructures, such as Clinics and Hospitals.
- **71** School infrastructures, with classrooms, bathrooms, and teacher housing.
- **64** Road projects, improving and construction rural roads.

The work model implemented by Mano a Mano Bolivia ensures the sustainability of all the social projects. Currently all of them are in operation since the day of their inauguration.

Participation in each of the projects includes:

- Municipalities participate with an economic counterpart; monitoring through their technical staff and guarantees the resources for the operation and permanent maintenance.
- The community during the execution of the project participates as a voluntary work, and after inauguration monitoring the proper use of the infrastructure.

- Mano a Mano Bolivia manages the financial counterparty to complete the budget through voluntary organizations and friends; executes projects under direct management, efficiency and ensures the quality of the infrastructure.

With this Working Model construction costs are approximately 40% lower than commercial costs, in addition including the equipment. Infrastructure is inaugurated after a period of 4-5 months of work.

The human resources for the operation of each completed infrastructure are responsibility of the Bolivian State through the ministries of health and education, as well as the municipality.

Current Situation and Justification

Huayquiri is a recently created rural community, located 26 km from the municipality of Luribay, belonging to the valley region of the department of La Paz, with low-cost housing built under the Bolivian government's housing improvement program and a local population of 355 inhabitants.



Photograph 1. Panoramic view of the community of Huayquiri, with typical houses built by the state housing program of the central government.

The recently created **Huayquiri** elementary school used two improvised classrooms built by the community using their own resources. One of the rooms, belongs to the community union.

The student population is at the moment **27** students distributed in five grades from kindergarten to 5th of elementary school (initial level, 1st and 2nd section, 1st to 5th of elementary school) with **2** teachers.

The school has a latrine in bad conditions, used by students and teachers.

The teachers live in two improvised rooms provided by the community and use the same bathroom facilities as the students.

Today the elementary school has:

- Two makeshift classrooms, the first belongs to the union headquarters, and the second, built due to student demand to provide classroom for the following grades. Both rooms were built by the community using its own resources.
- The housing for teachers, it is only one improvised room, also built by the community, with a shared kitchen and no own bathroom.
- The latrine is in bad conditions, which is used by teachers and children who attend school.

The indirect consequences of these problems are:

- Students and teachers without adequate classrooms do not have good pedagogical performance.
- Some students from the community prefer to go to schools in other communities because they are in better condition, which causes separation from the family unit and abandonment of their community.
- Teachers who come from cities present job dissatisfaction as a result of the lack of adequate living conditions in current homes.



Photograph 2. Front view of the current classroom at the Huayquiri school.



Photograph 3. The union headquarters, used as a classroom.



Photograph 4. Exterior view of the second classroom built with community resources.

Geographic Location:

The community of Huayquiri, located in the Municipality of Luribay, Loayza province of the Department of La Paz, is a 7-hour drive from Cochabamba, 372 km of which, 86 km are dirt and gravel roads that are dangerous during the rainy season. The community is located in the high plateau region of the country, with a cold climate.



Photograph 5. Initial, first and second grade students.



Photograph 6. View of the rooms of the teachers used as housing and with a shared kitchen.



Photograph 7. Interior of the room assigned as housing for the school teachers.



Photograph 8. Latrine without shower used by students and teachers

Economic Situation

The inhabitants of the community base their economy on the agricultural production of potatoes, barley and korn, the raising of poultry and other animals on a small scale. More than 50% of the population speaks two languages, Aymara and Spanish.

The municipality of **Luribay** presents a human development index (HDI) of **0.57 classified as a medium index**, according to the United Nations development program; **77% of the population of the municipality of Luribay is poor**, which means that they live below the poverty line established as a standard for Bolivia. (According to the Bolivian National Institute of Statistics)

The municipality of **Luribay** and the community of **Huayquiri**, due to their limited government budget allocation, do not have enough of their own resources to build new classrooms, housing for teachers and a bathroom for the local school, for this reason they seek help to solve this problem and need.

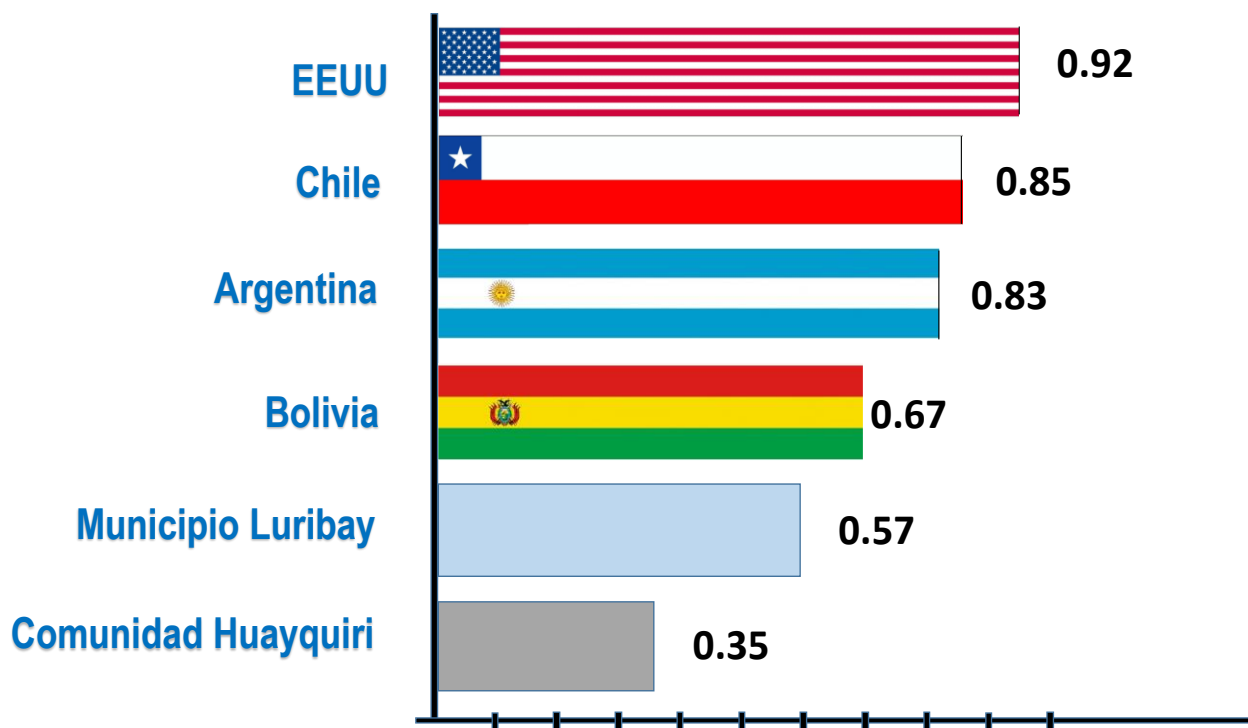

Graph 1. Comparison of the International Human Development Index (HDI) with the local HDI of the Municipality of Luribay and of the Huayquiri community.

The community of **Huayquiri** and the Municipality of **Luribay** have asked Mano a Mano Bolivia for help to solve this infrastructure problem, with its great importance and social impact.

Overall Project Objectives

General Objective:

- Build a school infrastructure in the community of Huayquiri.

Specific Objectives:

- Build 3 new classrooms, 2 housing for teachers and a bathrooms.
- Furnish and equip the school, the new housings, in coordination with the local municipality.
- Motivate and ensure community participation as volunteer job during the construction.

Project Scope

As a social development project, it seeks to achieve an impact on the quality of life, study and work of students and teachers through:

- Decrease in school dropouts, especially for girls due to lack of school infrastructure.
- Improve the implementation of the educational system and therefore the performance of students and teachers.
- Improves the job satisfaction for teachers and also students.
- Increased economic, social and cultural development of the region.
- Promote the local permanence of the inhabitants, decreasing internal migration.

Beneficiaries

The direct beneficiaries will be the current **27** students, boys and girls between 4 to 10 years old and the **2** teachers, who leaves and work in the same community. The students come from Huayquiri and other neighbor communities. The indirect beneficiaries are **355** habitants of Huayquiri and neighboring community.

Project Characteristics

The Project to be constructed under direct administration consists in **3 new classrooms, 2 housings for teachers and one bathrooms, with 294,00 m²** of constructed surface. The infrastructure will be based on brick and cement, with a ceramic floor and large aluminum windows, metal doors, adequate electrical installation and artificial lighting; All the design according to the climate and norms of the area.

Each classroom with capacity for 30 students, will be equipped with 15 school bi-personal desks and 31 chairs, metallic medium desk, a metallic showcase (Everything except the metal showcases will be constructed in the Organization workshops) besides each classroom will have material for cleaning and a bag with personal cleaning materials for each student. The homes will be equipped with two beds and a piece of toiletry equipment each, and another piece of equipment will also go for the bathroom.

Project Participation

Huayquiri community and the neighboring communities, will have the following responsibilities:

- Provide a minimum financial contribution.
- Provide adequate land to develop the project.
- Participate as volunteers supporting builders during the construction process.

Luribay municipal government: The municipality and its authorities will have the following responsibilities:

- Provide a financial contribution as a counterparty.
- Contribute local building materials.
- Participate in the supervision of the process of construction.
- Perform a continuous maintenance of the infrastructure.
- Guarantee the sustainability and operating costs of the infrastructure, including teachers.

Mano a Mano Bolivia: As the managing and executing organization of the project, will have the following responsibilities:

- Find counterpart funds to complete the total project budget.
- Develop the architectural plans of the project in coordination with the community and the municipality.
- Perform the project under direct administration, securing the quality and achievement of the plans.
- Supervise the construction of the project through their own personnel.
- Perform the equipment in coordination with the community and the municipality
- Perform the opening and public inauguration according to the established plans.
- Submit partial reports of the construction process, including final reports, economic reports, expense reports and audiovisual reports, to the financiers.

Supporting / Funding Organization: As the supporting or counterpart funding organization of the project, you will have the following responsibilities and entitlements.

- Complete the project budget as a counterpart, managed by Mano a Mano Bolivia.
- Verify and demand compliance with the execution of the project according to the signed agreement.
- Participate as volunteers during the construction process according to the established plan.
- Participate in the inauguration of the new infrastructure.
- Receive all the information on the construction process and reports on a regular basis.
- Receive the final information of the construction process, economic, backup, and audiovisual.

Budget of project

The total cost of the project is **724,140.00 Bs.**

Table 1. Project budget (in bolivianos).

Category	Description	Amount (Bs)
1. DIRECT COSTS		578,706.00
Preliminary Works	Site inspections, proposals, informational materials, videos, etc.	6,670.00
Construction Materials	Includes aggregates, cement, bricks, steel, plumbing & sanitary, electrical, roofing and ceilings, flooring, painting, carpentry (wood, metal, aluminum), tools, equipment transport, and contingency (5%).	381,925.00
Professional Services	Project staff, supervision staff, and operational supervision costs (vehicles, fuel, lodging, etc.).	56,000.00
Labor & Related Costs	Skilled masons, plumbing, electrical, carpentry installations, and legal/tax obligations.	134,111.00
2. INDIRECT COSTS		145,434.00
Equipment & Inauguration	Furniture, supplies, additional equipment, contingency, and inauguration event.	93,434.00
Administration & Training	Administrative costs, training for staff and community health promoters (3 years), infrastructure contingency (3 years), and essential supplies (3 years).	52,000.00
TOTAL, GENERAL BUDGET		724,140.00 Bs

Table 2. Financial participation in the project (in Bs)

Project participants	Community	Municipality	Financial Support	Total
Total amount each participant will contribute to the project	14,483.00	420,001.00	289,656.00	724,140.00
Percentage of participation	2%	58%	40%	100.00%
	60% of the total budget 434,484.00		40% of the total budget 289,656.00	

Graphic 2. Cost Comparison – Market Rates versus Proposed Costs by Mano a Mano Bolivia.

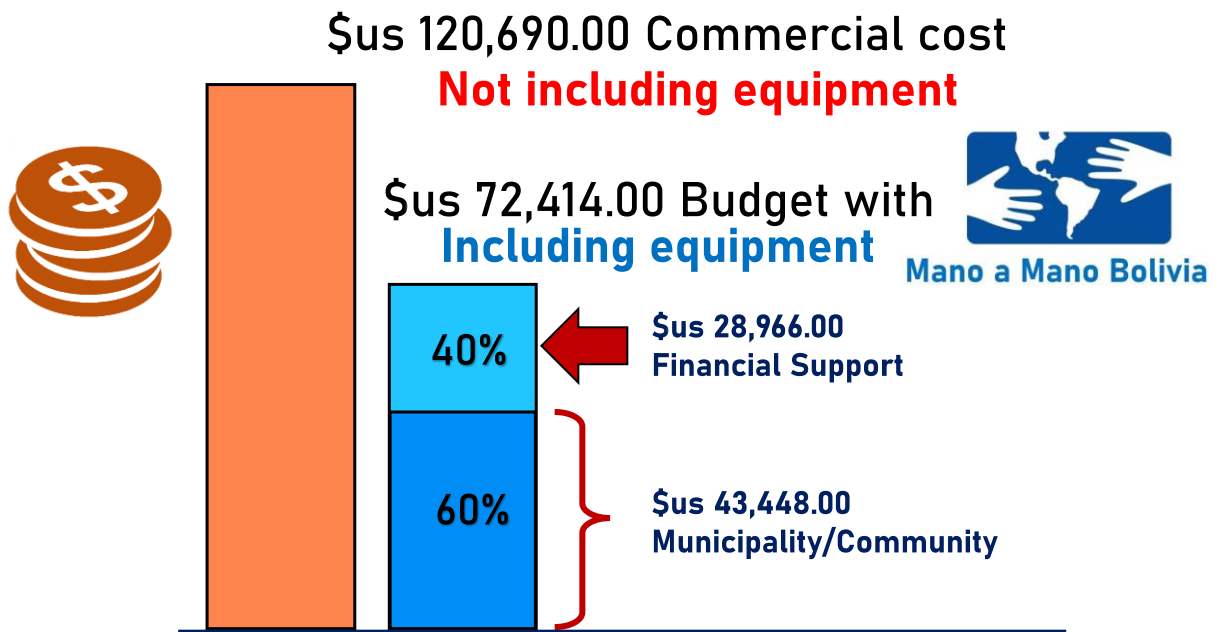

Important Note:

- Without our support, **Huayquiri** and the municipality will expend **1'206,900.00 Bs** to make the same project with commercial company, not including the equipment.
- The cost of the project with our methodology is **724,140.00 Bs** which means 40% less than the commercial cost including also all equipment
- The municipality and the local community together can just have the 60% of the total budget which means **434,484.00 Bs**.
- Without the participation and financial extern help of **289,656.00 Bs (\$us 28,966)**, this project cannot be done.

Project blueprints

Graph 3. Plans of the classroom project and bathroom battery renovation.

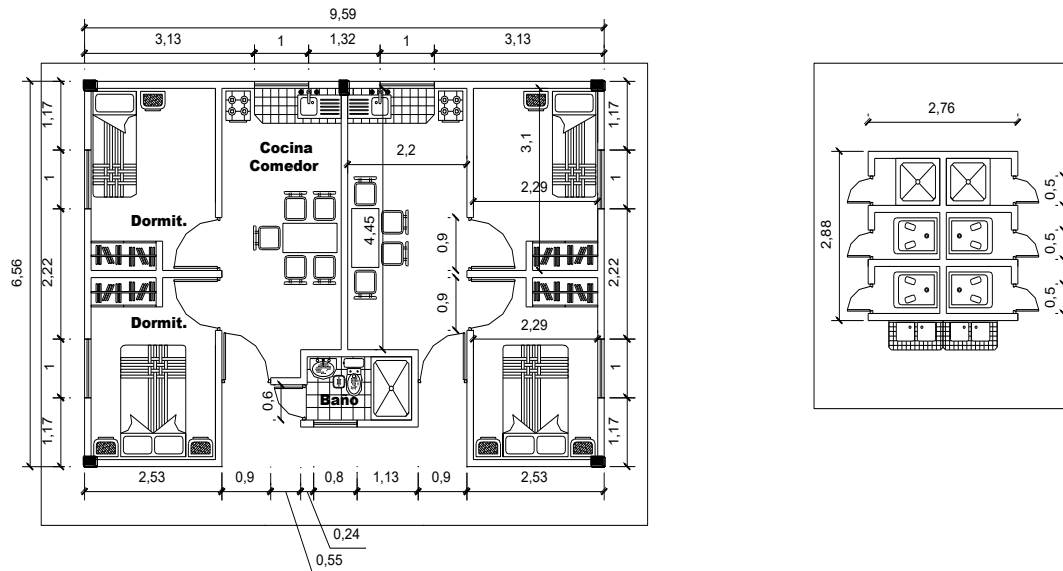
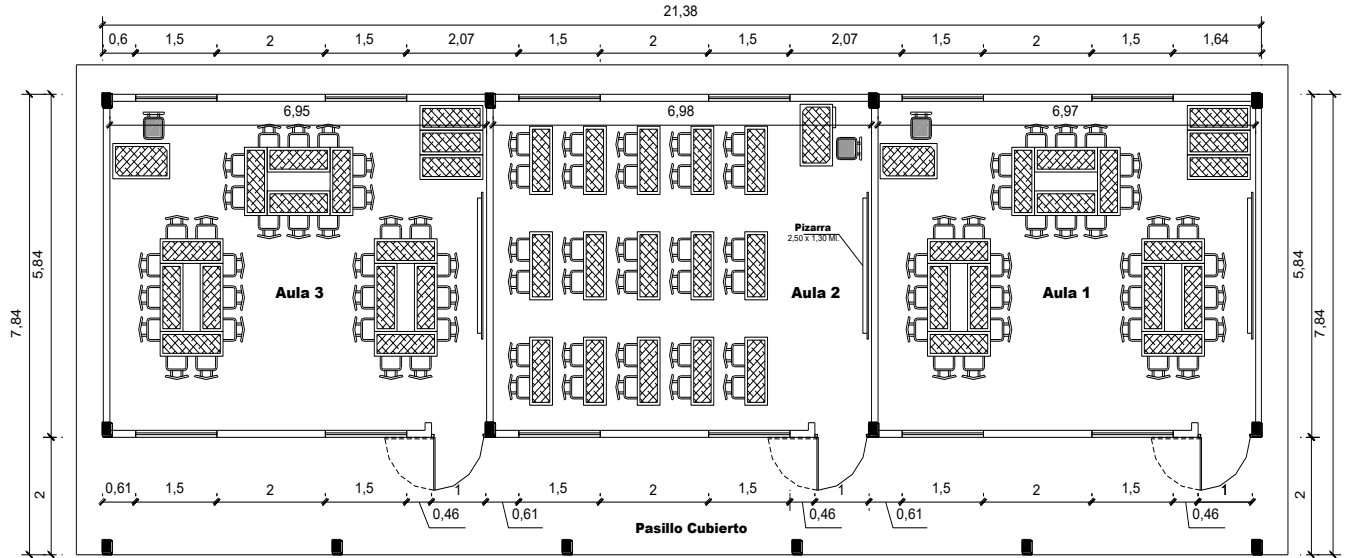

Photographs 10.11. Completed similar projects.



Image of a school with three new classrooms and a bathroom (Litus Pampa Community – Aiquile)



Front view of a housing for teachers (Guitarani Community – Icla)

For more information, questions or more details about this project please contact:



Lic. Aida Suárez T.
Administrator – Accountant



Arq. Elizabeth Montaña V.
Constructions Department

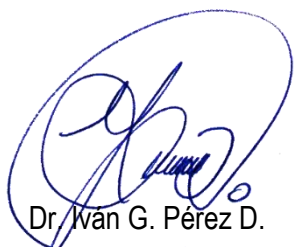

Dr. Iván G. Pérez D.
Planning Department

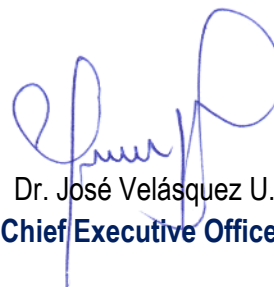



Dr. José Velásquez U.
Chief Executive Officer

Cochabamba, September 2025

 Villazón Avenue, Km 3,8 - Cardenal Terrazas Street N° S 395, Quintanilla District, Cochabamba - Bolivia

 Tel.: 4722584 /5.  +591-72202345.

 www.manoamanobolivia.org  info@manoamanobolivia.org

 www.facebook.com/ONGManoaManoBolivia